

Glena Avenue

KNOWLE

APPROXIMATE FLOOR AREA
SQM 140 / SQFT 1513



GROUND FLOOR

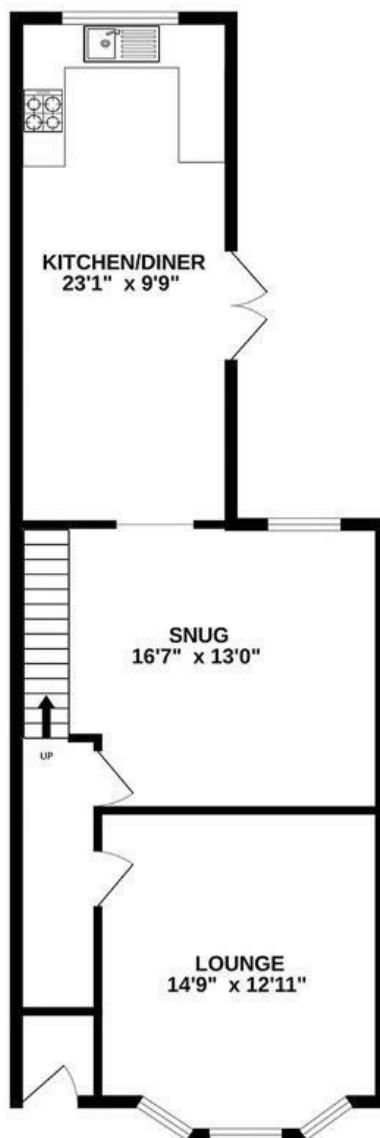

FIRST FLOOR



SECOND FLOOR



ly, measurements are approximate, not to scale.

Boardwalk

Glena Avenue , BRISTOL

£

£595,000

zzz

4 Bedrooms



BS4 2LB



2 Bathrooms

"We've loved living on Glena Avenue for over 30 years, it's been a wonderful area to raise our 3 children. We've particularly enjoyed living close to several beautiful parks, having picnics and watching the sunset at Perretts has been a favourite. There's plenty of lovely places to eat locally, our favourite is A cappella which is only a few minutes walk. Having a local swimming pool has been great, all our children learnt to swim there. We have so many fond memories of living in Knowle."

